

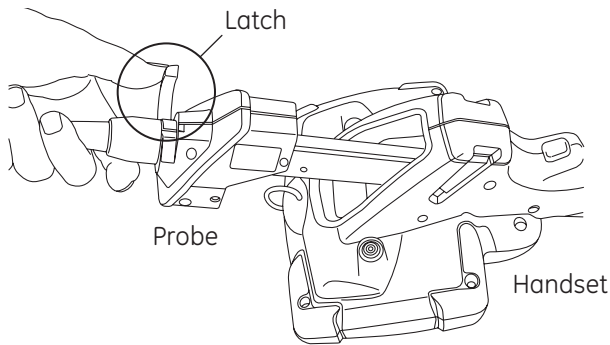

XLG3ABSA Installation Guide



Step 1

Remove existing probe from handset

1. Shut down the probe.
 - a. While viewing a live or frozen image, press .
 - b. Select "Probe Shut Down".
2. Open the probe latch. The probe pops out slightly.
3. Gently slide the probe out of the handset.

Install probe adapter into handset

1. Open the probe latch.
2. Slide the probe into the handset.
3. Close the latch.

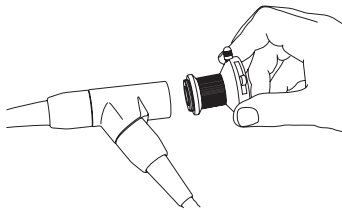

Step 2

Thread in correct C-mount coupler.

NOTE: C-mount coupler information located on back page.

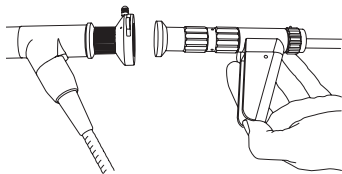

Step 3

Snap rigid into C-mount coupler.

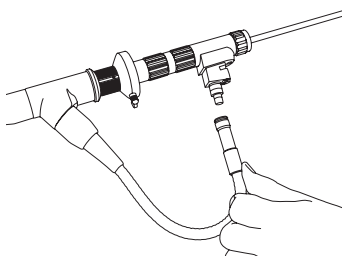

Step 4

Snap borescope adapter light guide to the rigid light post.

NOTES:

- Requires correct light post adapter based on rigid borescope manufacturer.
- See light post adapter information on back page.

Completed set-up

Correctly assembled product should look like illustration on the right.

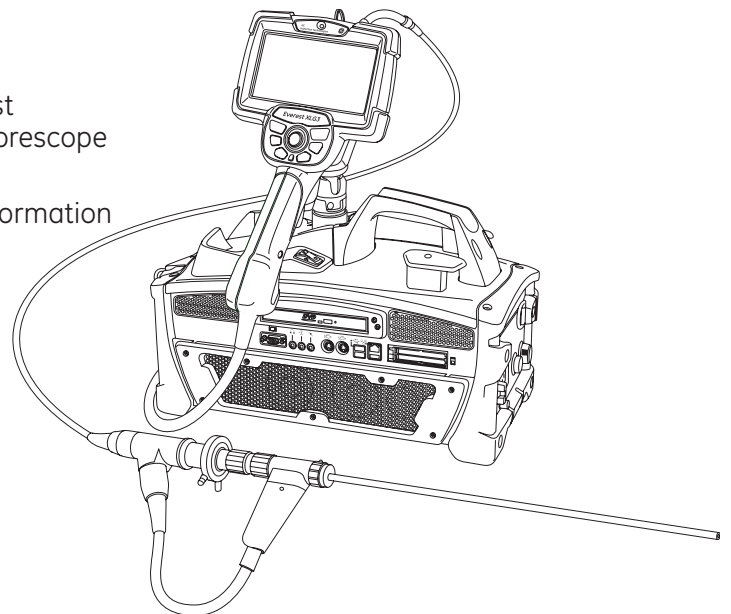

C-mount coupler options*

(*Must be ordered separately.)

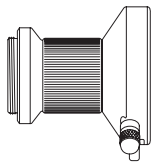

Part Number: **CCF28**
Variable Focus C-mount Camera Coupler
28 mm focal length (best for rigid borescopes > 4 mm Ø)

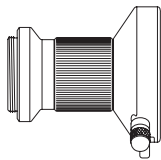

Part Number: **CCF35**
Variable Focus C-mount Camera Coupler
35 mm focal length (best for fiberscopes and 2.7 mm Ø mini-rigid borescopes)

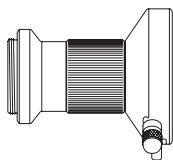

Part Number: **CCF45**
Variable Focus C-mount Camera Coupler
45 mm focal length (best for mini-rigid borescopes and mini-semi-flexible fiberscopes <2 mm Ø)

Rigid post adapter options

The XLG3™ borescope adapter part number XLG3ABSA is supplied with light guide exit adapter part number LGA-PAF. It is compatible with all GE Inspection Technologies' rigid borescopes and fiberscopes.

Customers wishing to adapt to other manufacturers' products can utilize the following accessory adapters*. (*Adapters are sold separately.)

Part Number: LGA-PS	Storz female fits Storz borescope post
Part Number: LGA-PAM	ACMI male fits Olympus borescope post
Part Number: LGA-PWF	Wolf female fits R. Wolf borescope post

Service Offices

USA 888-332-3848
973-448-0077

Germany +49 7471 98820

Hong Kong +852 2877 0801

email: rvi-info@ge.com

